

# SUPER EASY PRO

ELECTRO SAILPLANE

# V2



Manufactured by:

**TOPMODEL CZ**

679 05 HABRŮVKA 100 - CZECH REPUBLIC

www.topmodelcz.com

e-mail: info@topmodelcz.cz

Order N°: 020141



1190mm

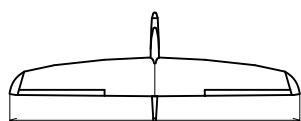

1910mm

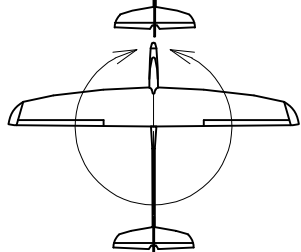

43,8dm<sup>2</sup>  
27,4-29,7g/dm<sup>2</sup>



1,2 - 1,3kg



S3021

Radio system you'll need :

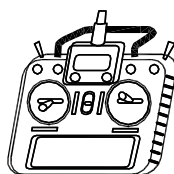

- ailerons - 2 servos
- flaps - 2 servos
- elevator
- rudder
- motor

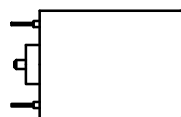

KAVAN C3536-1250

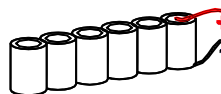

3S Lixx 2,2-3Ah

*Není-li uvedeno jinak, všechny  
neoznačené míry jsou v milimetrech*  
**UNLES STATED, ALL DIMENSIONS  
ARE IN MILIMETERS**

Položka	Název dílu	Materiál/rozměr	Volně/ks	Balíček/ks
	montážní návod		01	
1	trup	laminát	01	
1-1	motorová přepážka	sklotextit 3mm		01
1-2	držák serva směrovky	překližka 4x39x56mm		01
1-21	držák serva VOP	lipa 10x10x12		02
1-3	držák bovdeny	balsa 5x10x56 mm		01
2	křídlo	balsa	02	
2-1	křídélko	balsa	02	
2-11	klapka	balsa	02	
2-2	šroub křídla	M4x20mm		02
2-21	aretační kolík	laminát Ø3x30mm		01
2-25	aretační kolík	laminát Ø4x65mm		02
2-3	matice křídla	AL M4		02
2-31	podložka matice	překližka 4x25x51mm		01
2-4	držák serva	překližka 12mm		04
2-41	krytka serva	ABS folie		02
2-5	táhlo křídélka a klapek	ocel Ø1,8mm		04
2-6	vidlička	MPJ 2110		04
2-8	páka křídélka	sklotextit 1,5mm		02
2-81	páka klapek	sklotextit 1,5mm		02
24	spojka křídla	steel Ø5x170mm		01
3	VOP	balsa		01
3-1	klapka vop	balsa	01	
3-2	matice VOP	AL M3		02
3-4	šroub VOP	plast M3x15mm		02
3-5	táhlo VOP	ocel Ø1,8mm		01
3-6	vidlička kovová	kov MPJ 2140, matice M2		01+01
3-8	páka VOP	sklotextit 1,5		01
4	směrovka	balsa konstrukční	01	
4-3	steven	balsa 6mm		01
4-5	táhlo směrovky	bowden Ø3x900mm bowden Ø2x900mm ocel. drát Ø0,8x1000mm	01 01 01	
4-6	vidlička	MPJ 2110		01
4-65	koncovka táhla	MPJ 2762		01
4-7	spojka táhla	MPJ 2013		01
4-8	páka směrovky	sklotextit 1,5mm		01
6	kabina	laminát	01	
6-1	uchycení kabiny	laminát Ø2x200mm		01
6-2	skelná tkanina	20x80mm		01
6-21	podložka	překližka 3x6x12mm		01
7	obtisky			
11	závěsy kormidel	MPJ 2502		02

Part #	Part name	Material/dimensions	Loose	In bag
	building instruction		01	
1	fuselage	fibreglass	01	
1-1	motor mount	fibreglass 3mm		01
1-2	servo tray	plywood 4x39x56mm		01
1-21	elevator servo tray	wood 10x10x12		02
1-3	link support	balsa 5x10x56 mm		01
2	wing	balsa assembly	02	
2-1	aileron	balsa assembly	02	
2-11	flap	balsa assembly	02	
2-2	wing fixing screw	M4x20mm		02
2-21	centering pin	fibreglass Ø3x30mm		01
2-25	centering pin	fibreglass Ø4x65mm		02
2-3	wing nut	AL M4		02
2-31	nut mount	plywood 4x25x51mm		01
2-4	servo mount	plywood 12mm		04
2-41	wing servo cover	ABS plastic		02
2-5	aileron & flap pushrod	steel Ø1,8mm		04
2-6	clevis	MPJ 2110		04
2-8	aileron horn	fibreglass plate 1,5mm		02
2-81	flaps horn	fibreglass plate 1,5mm		02
24	wing joiner	steel Ø5x170mm		01
3	horizontal stabilizer	balsa assembly		01
3-1	elevator	balsa	01	
3-2	stabilizer nut	AL M3		02
3-4	stabilizer fixing screw	nylon M3x15mm		02
3-5	elevator link	steel Ø1,8mm		01
3-6	clevis metal+nut M2	MPJ 2140, nut M2		01+01
3-8	elevator horn	fibreglass plate 1,5mm		01
4	rudder	balsa assembly	01	
4-3	closing strip	balsa 6mm		01
4-5	rudder link	bowden Ø3x900mm bowden Ø2x900mm steel Ø0,8x1000mm	01 01 01	
4-6	clevis	MPJ 2110		01
4-65	Screw-lock pushrod connector	MPJ 2762		01
4-7	threaded rod tip M2	MPJ 2013		01
4-8	rudder horn	fibreglass plate 1,5mm		01
6	canopy	fibreglass	01	
6-1	canopy fixing	fibreglass Ø2x200mm		01
6-2	fibreglass fabric	20x80mm		01
6-21	cannopy fixing pad	překližka 3x6x12mm		01
7	stickers			
11	pinned hinge	MPJ 2502		02

Doporučená výbava				
		Kusů		Obj.číslo www.topmodelcz.com
servo	Servo ES 08 MD II	6		3531
motor	KAVAN C3536-1250	1		KAV30.0256
regulátor	KAVAN PRO-40SB	1		KAV32.31020
kužel	Ø40;4;8	1		0201558
listy vrtule	Graupner CAM FOLDING PROP 9/6"	1		1336.23.15
akumulátor	3S 2,2 - 3Ah	1		

RECOMMENDED EQUIPMENT				
		Pieces		Item No. www.topmodelcz.com
servo	Servo ES 08 MD II	6		3531
motor	KAVAN C3536-1250	1		KAV30.0256
controller	KAVAN PRO-40SB	1		KAV32.31020
spInner	Ø40;4;8	1		0201558
propeller	Graupner CAM FOLDING PROP 9/6"	1		1336.23.15
battery	3S 2,2 - 3Ah	1		

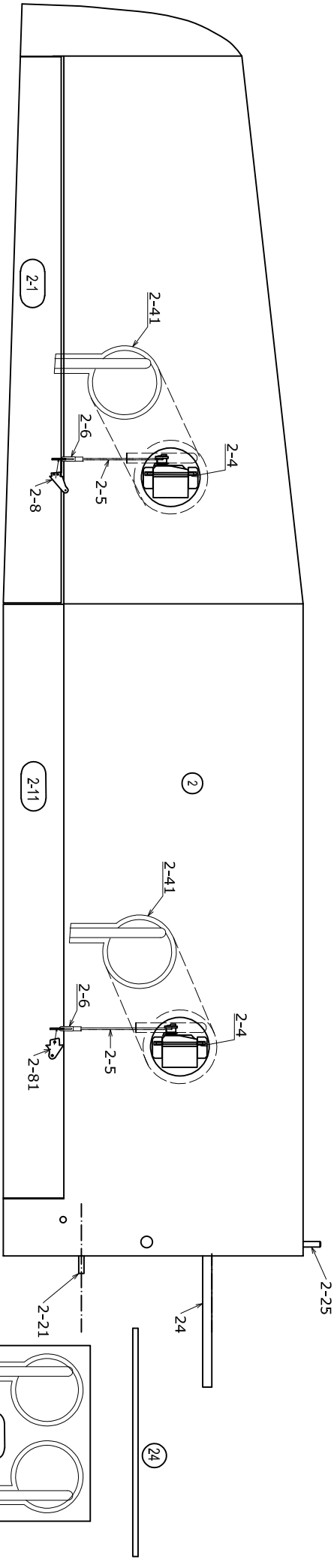
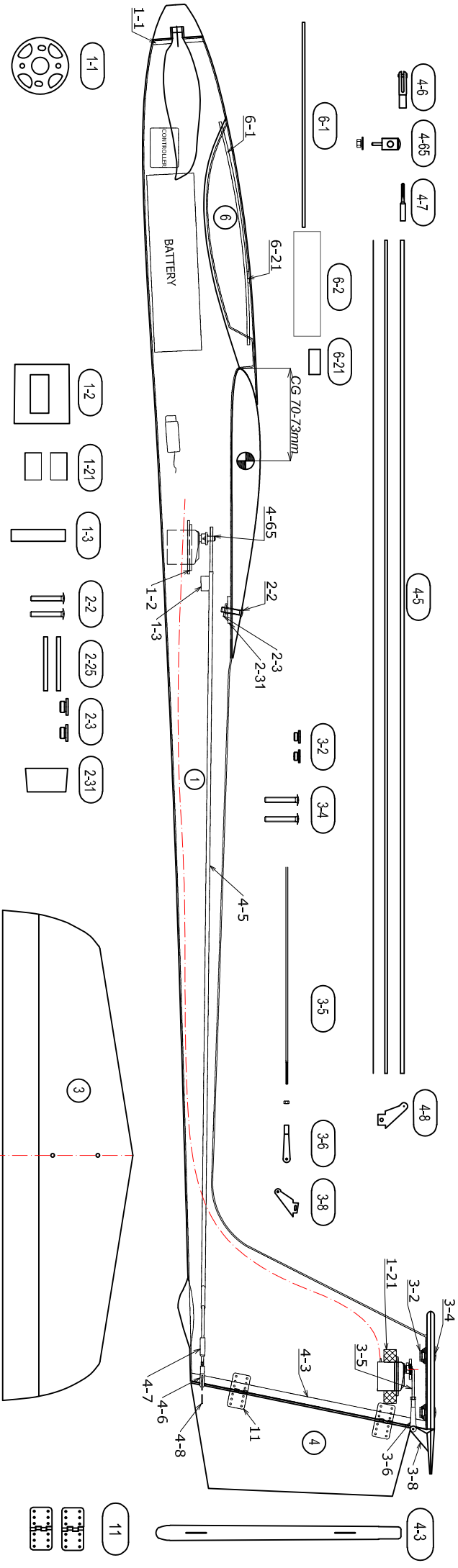

# SUPER EASY PRO V2

© TOPMODEL CZ Manufactured by TOPMODEL CZ s.r.o. 679 05 HABRŮVKA 100  
 www.topmodelcz.com e-mail: info@topmodelcz.cz

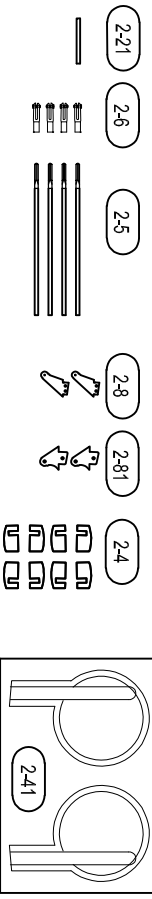

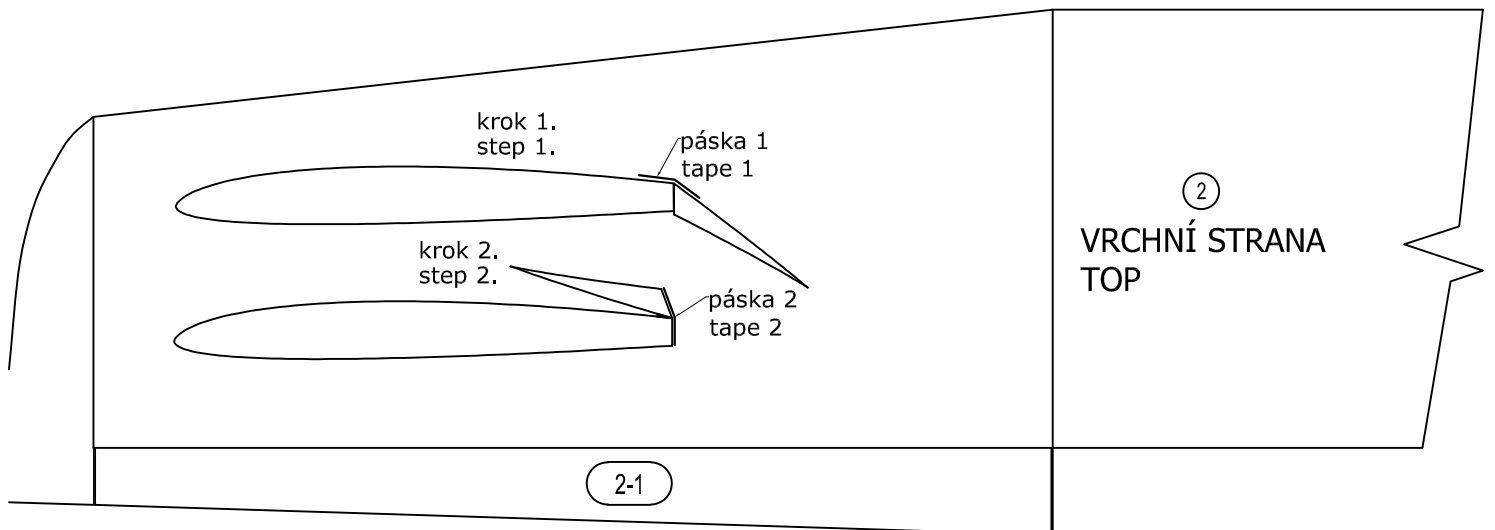
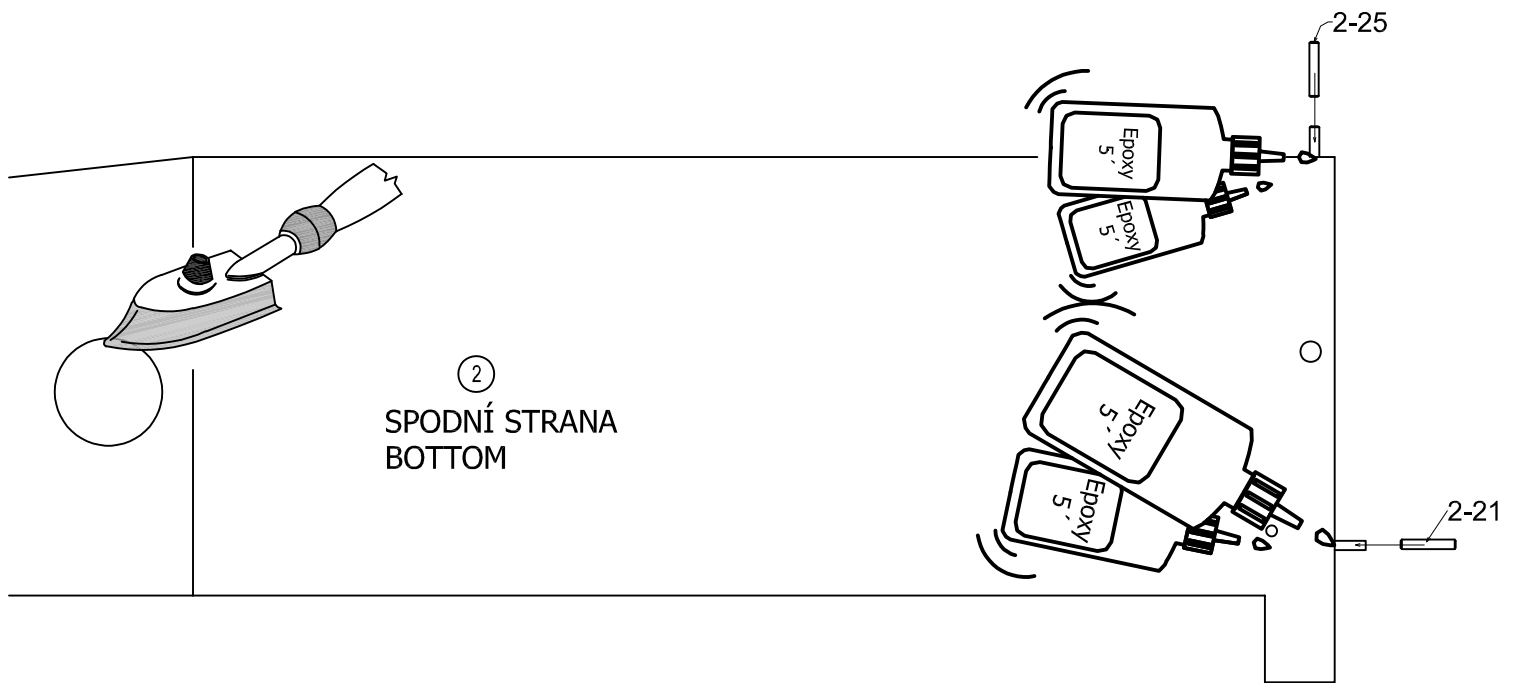
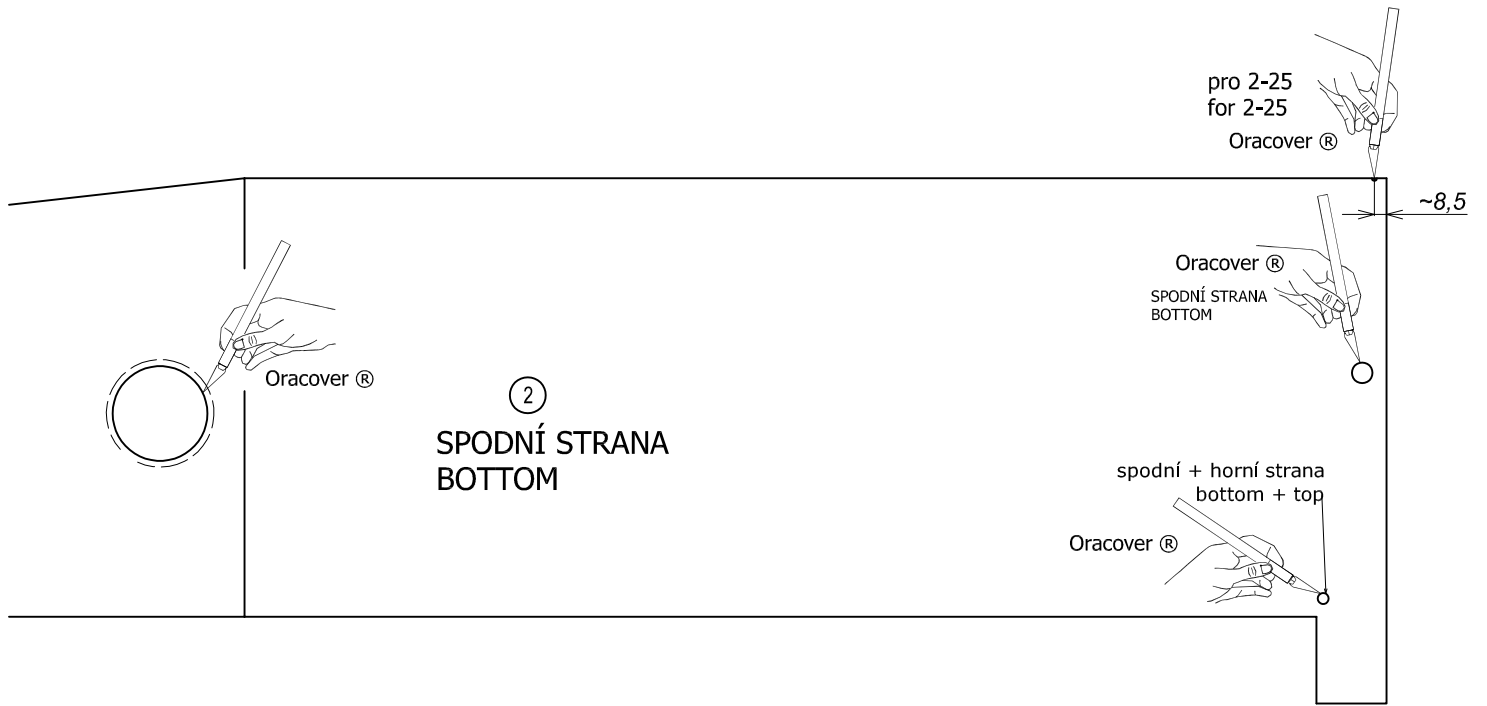

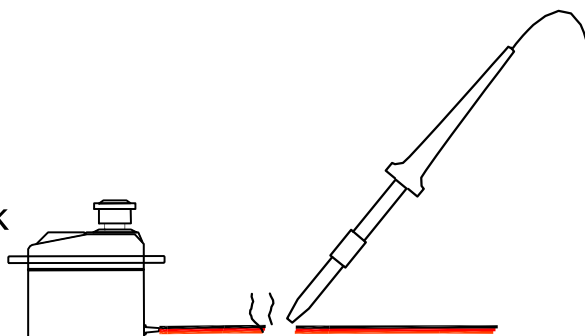
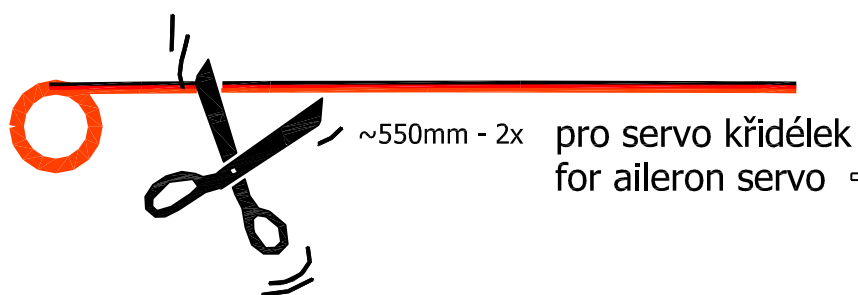
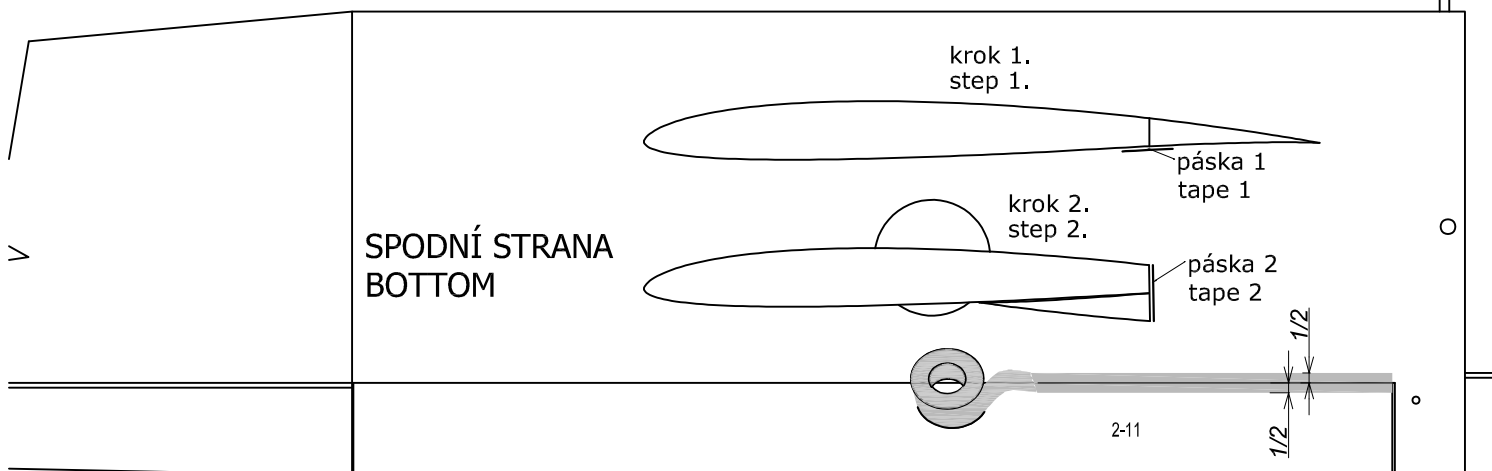
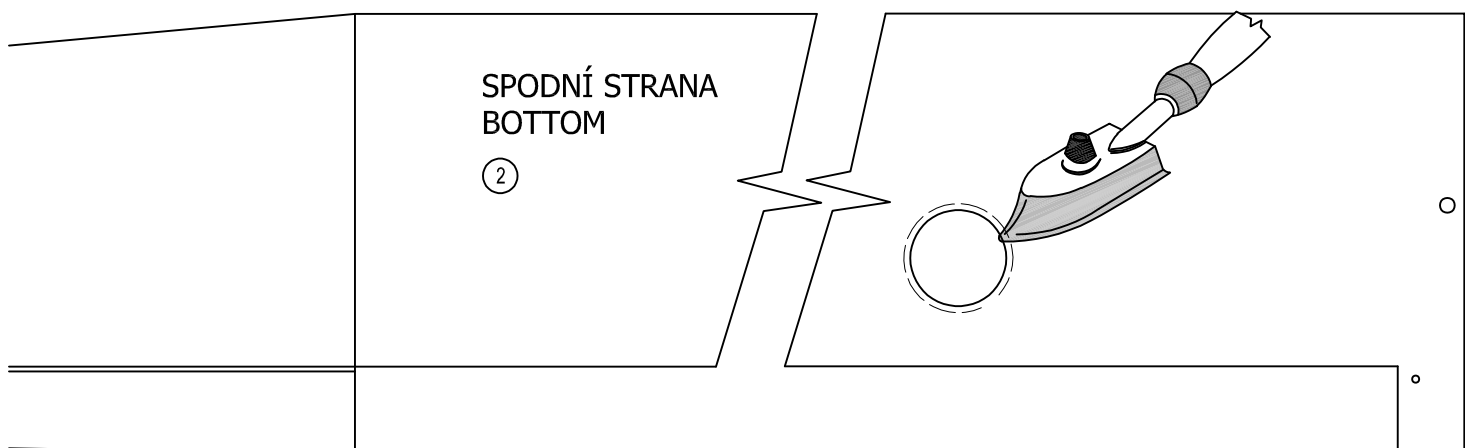
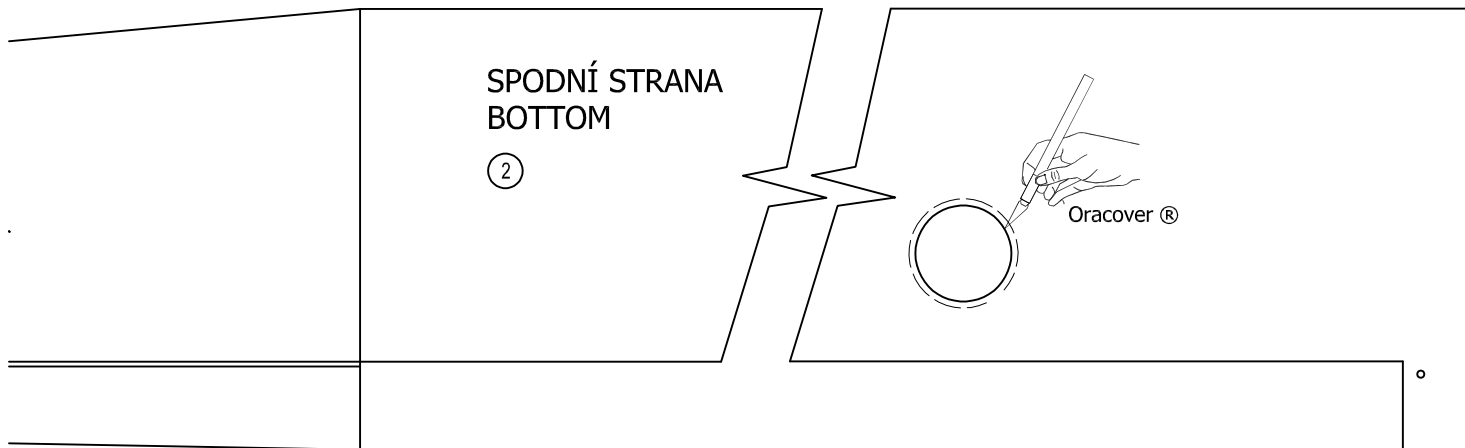

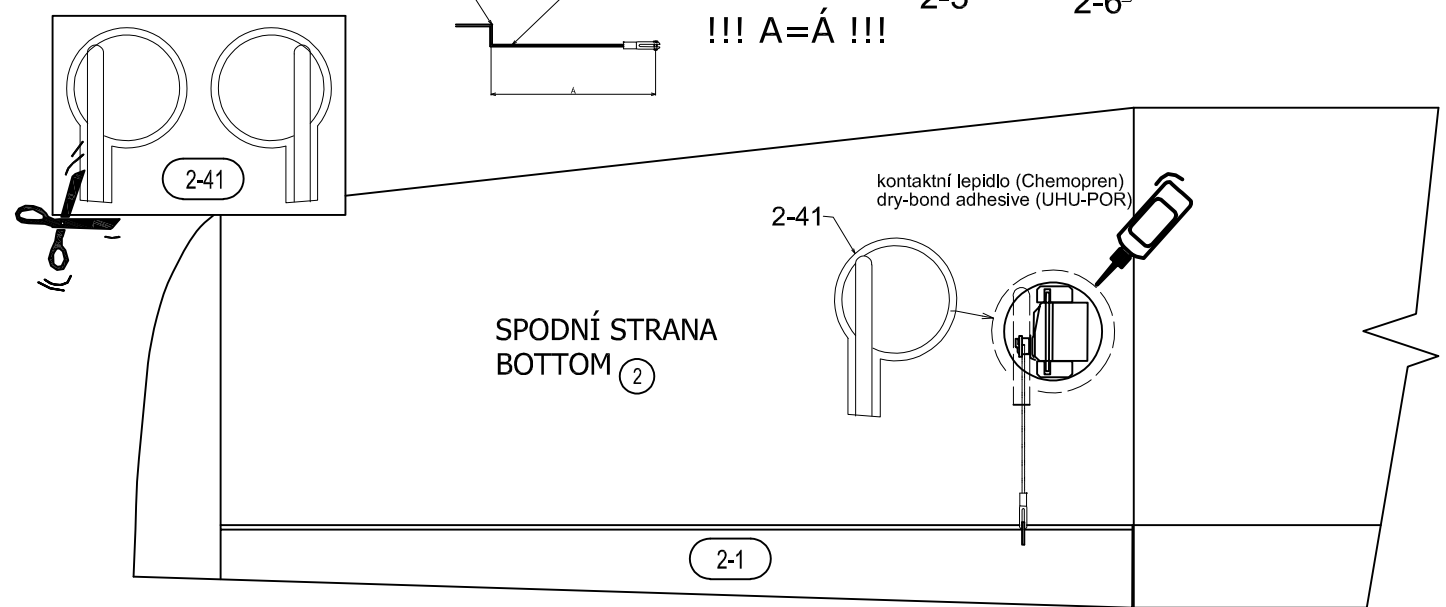
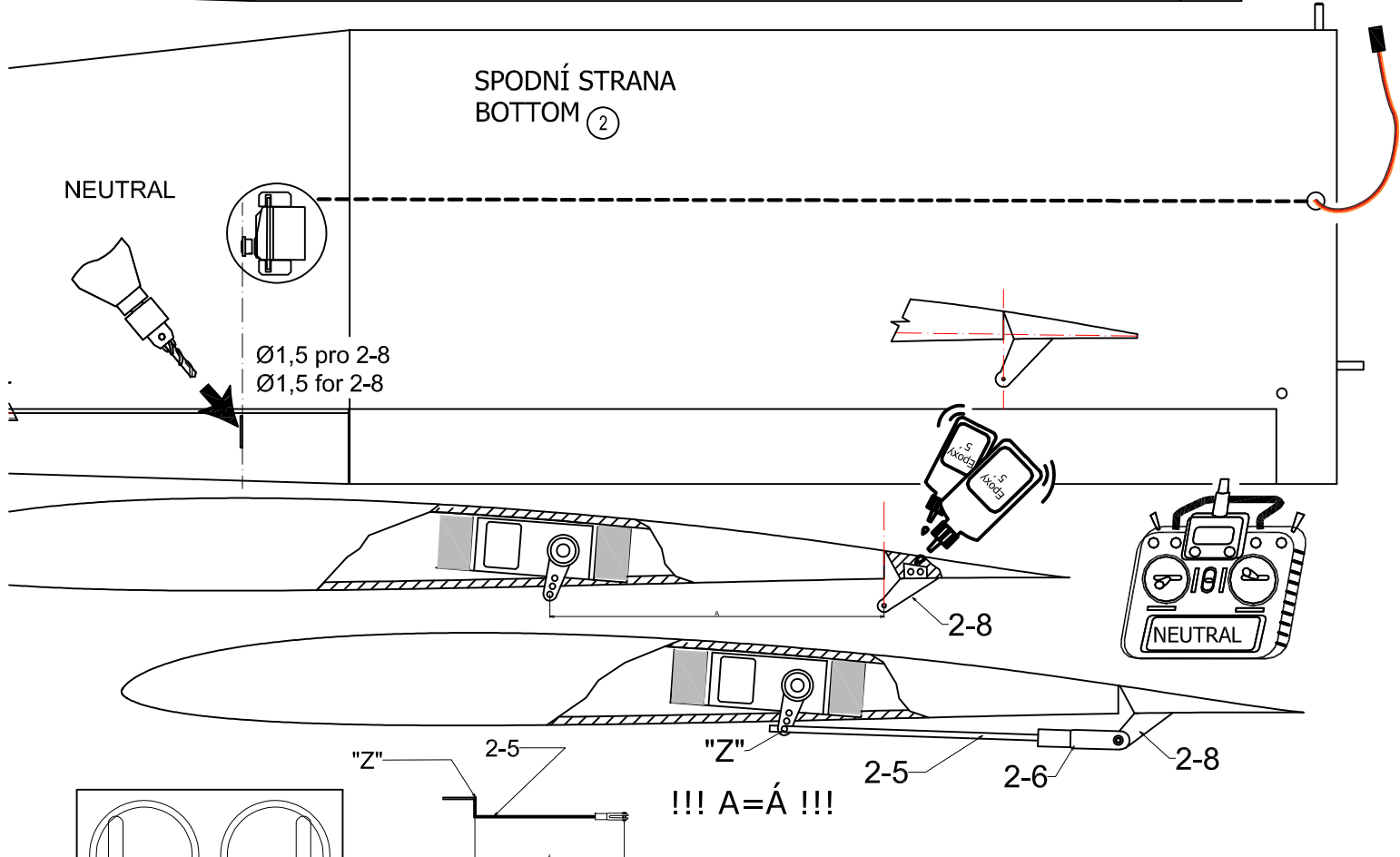
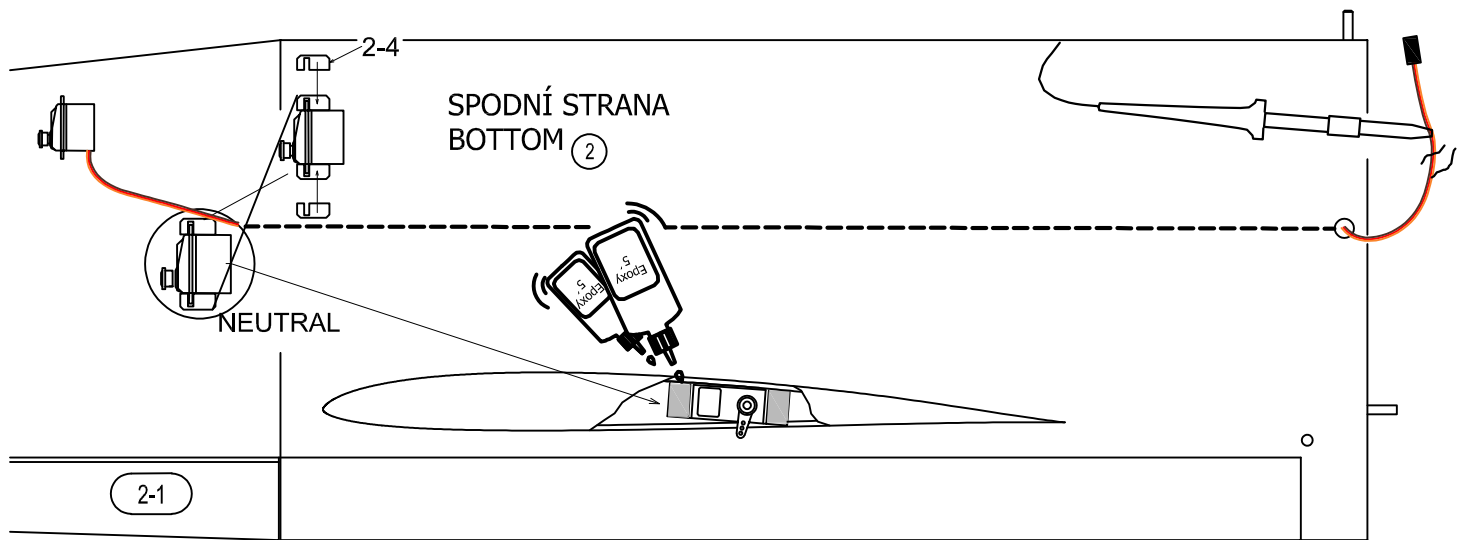

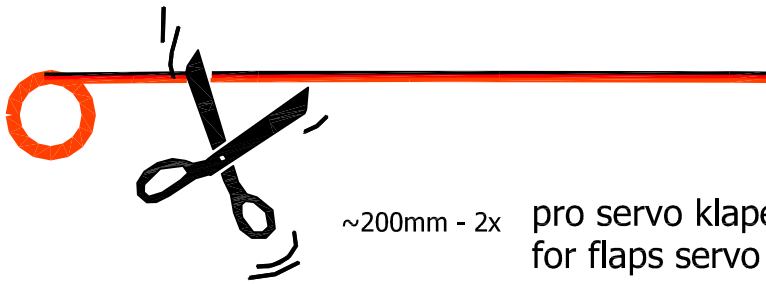

~200mm - 2x pro servo klapek  
for flaps servo

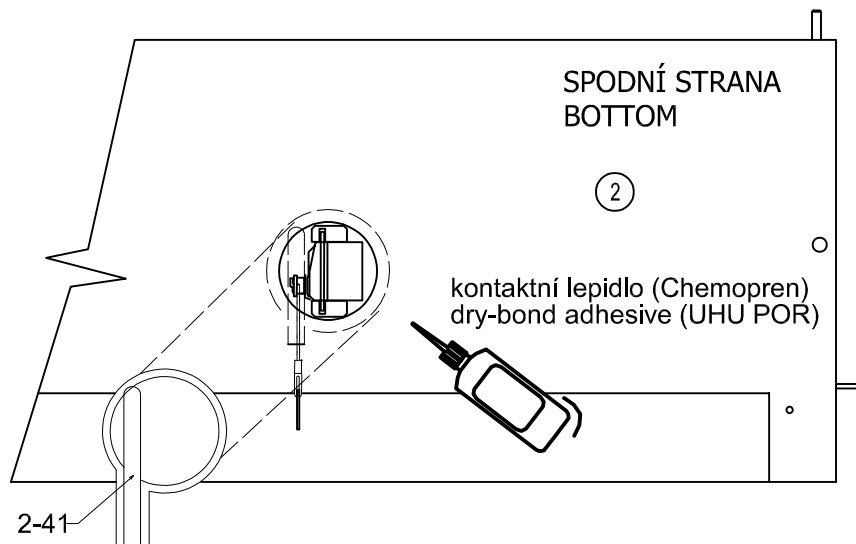
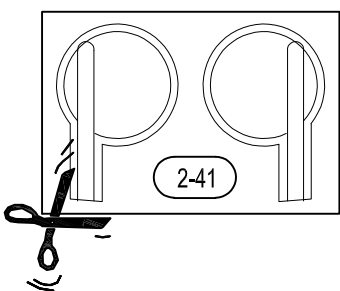
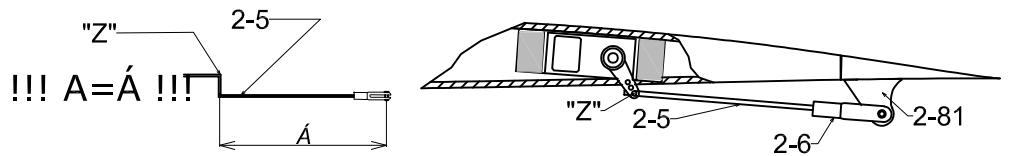
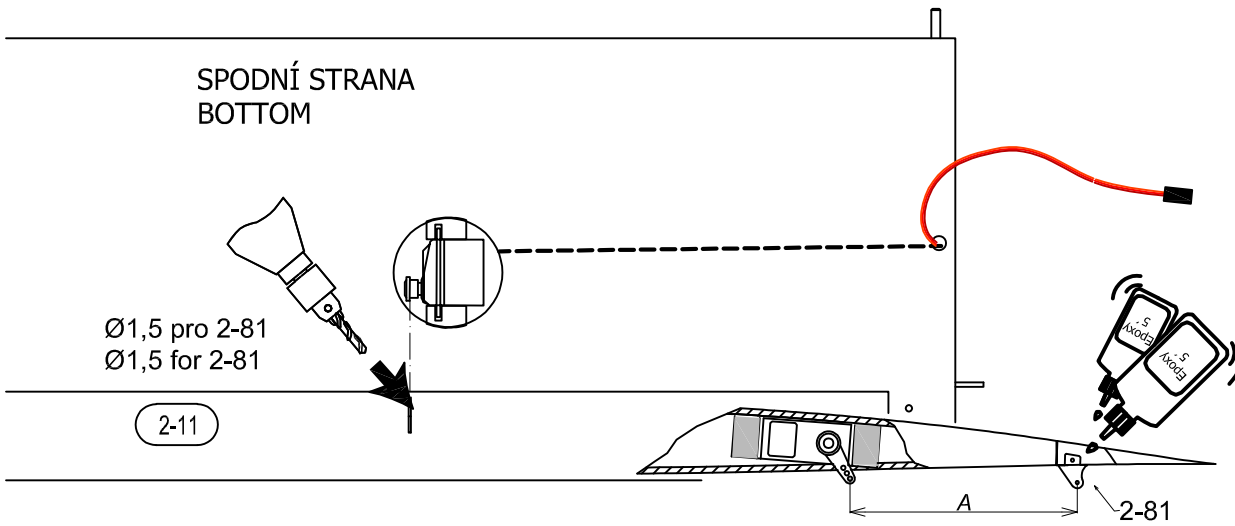
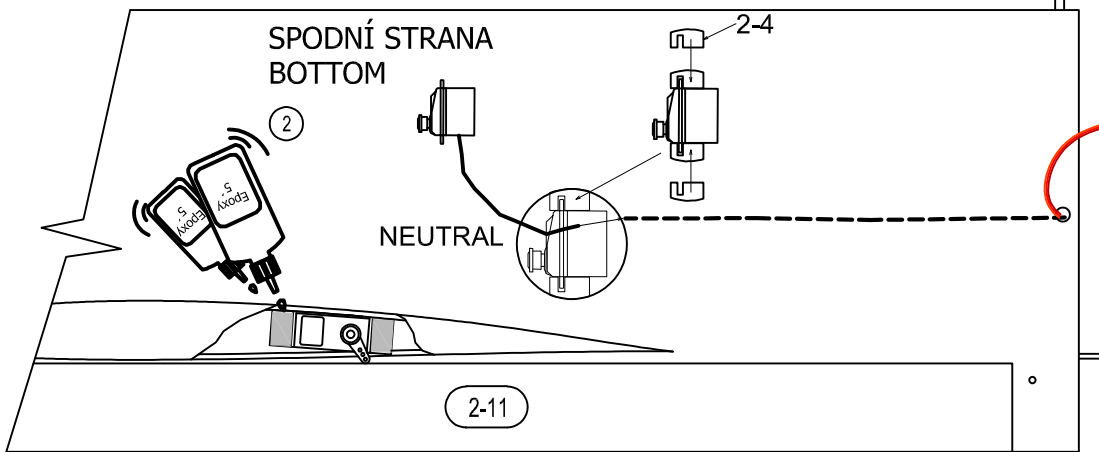
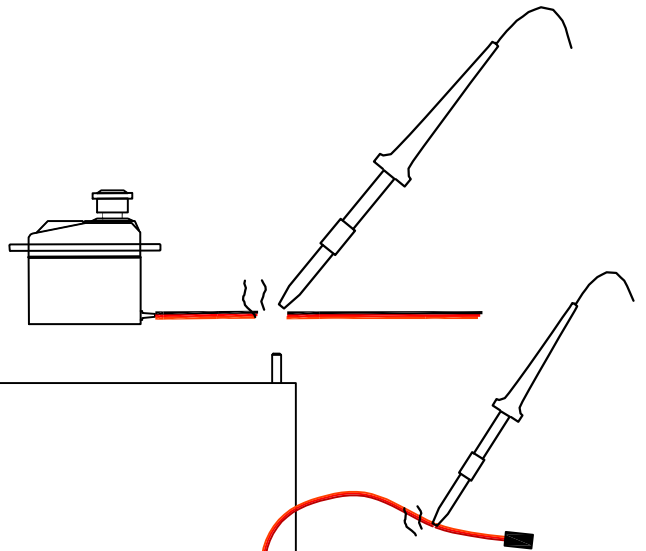

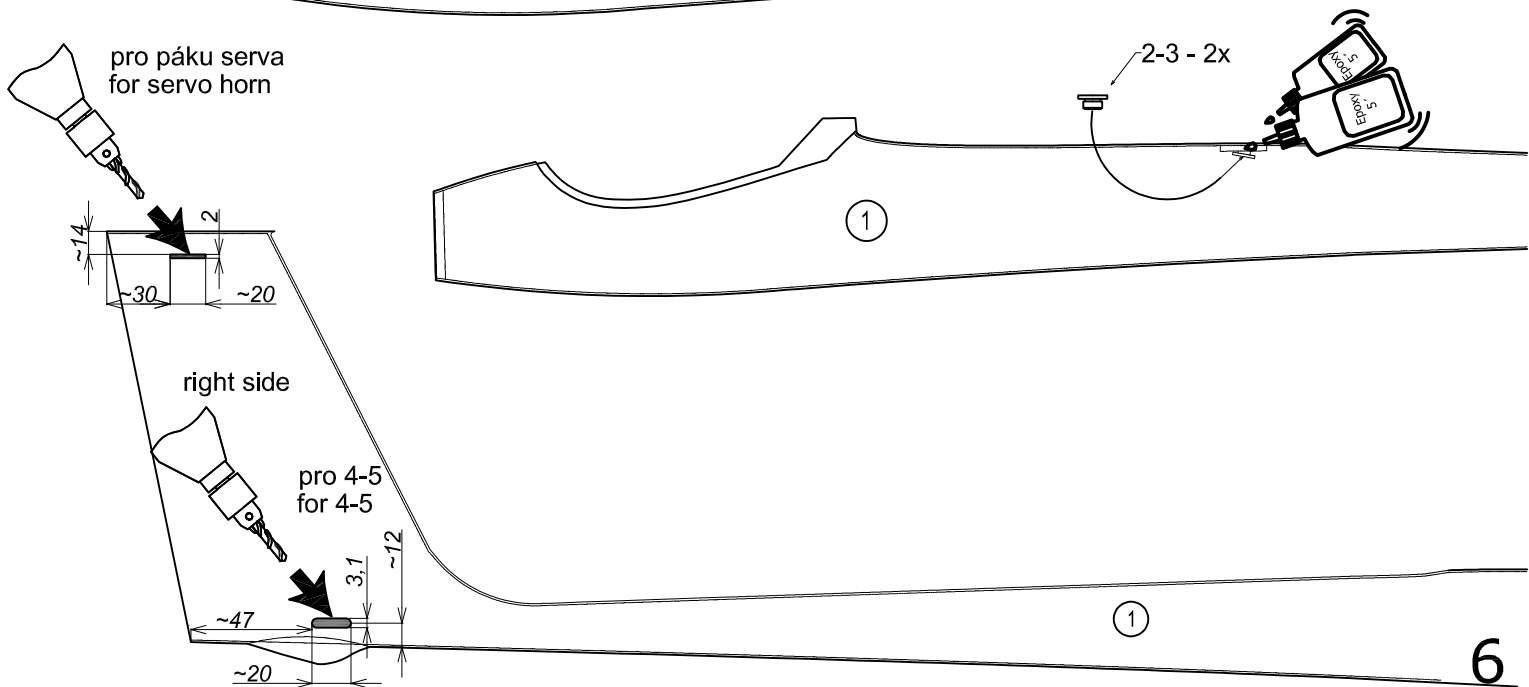
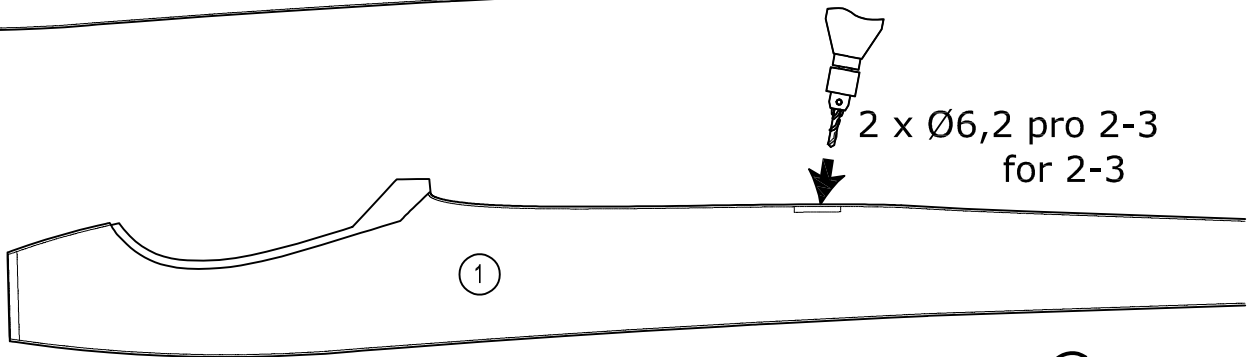
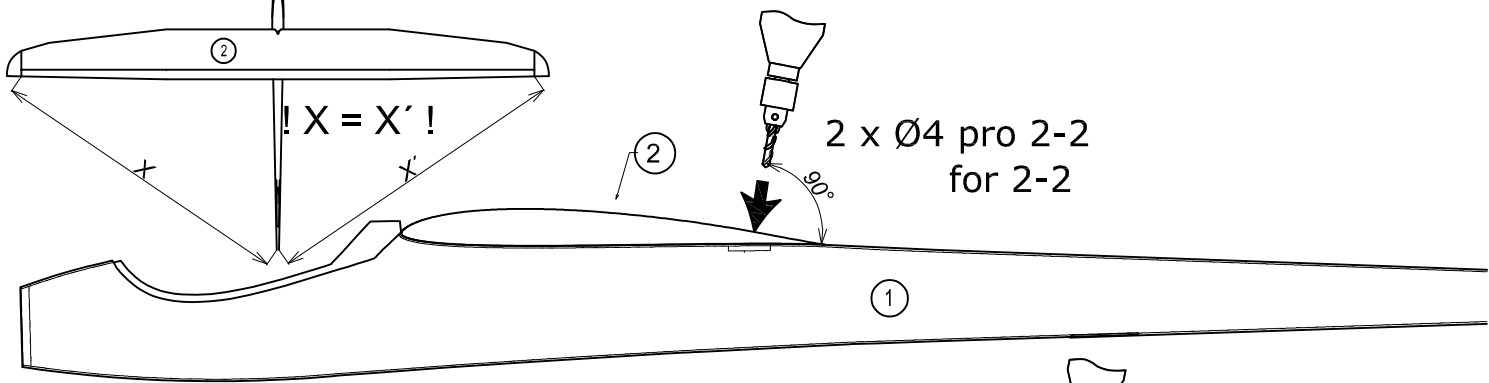
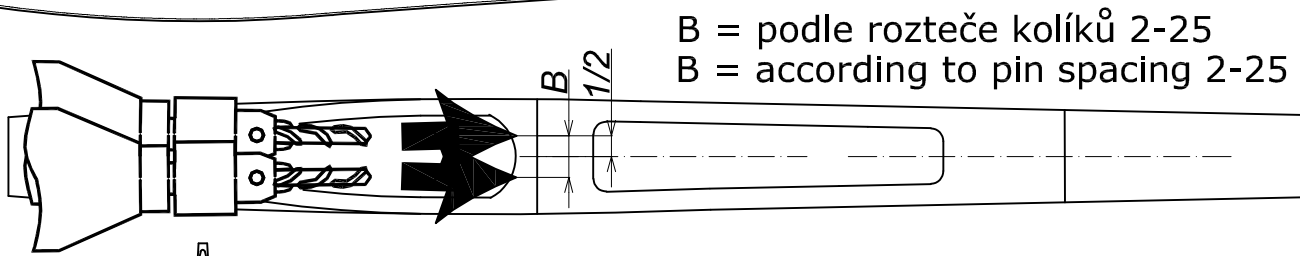
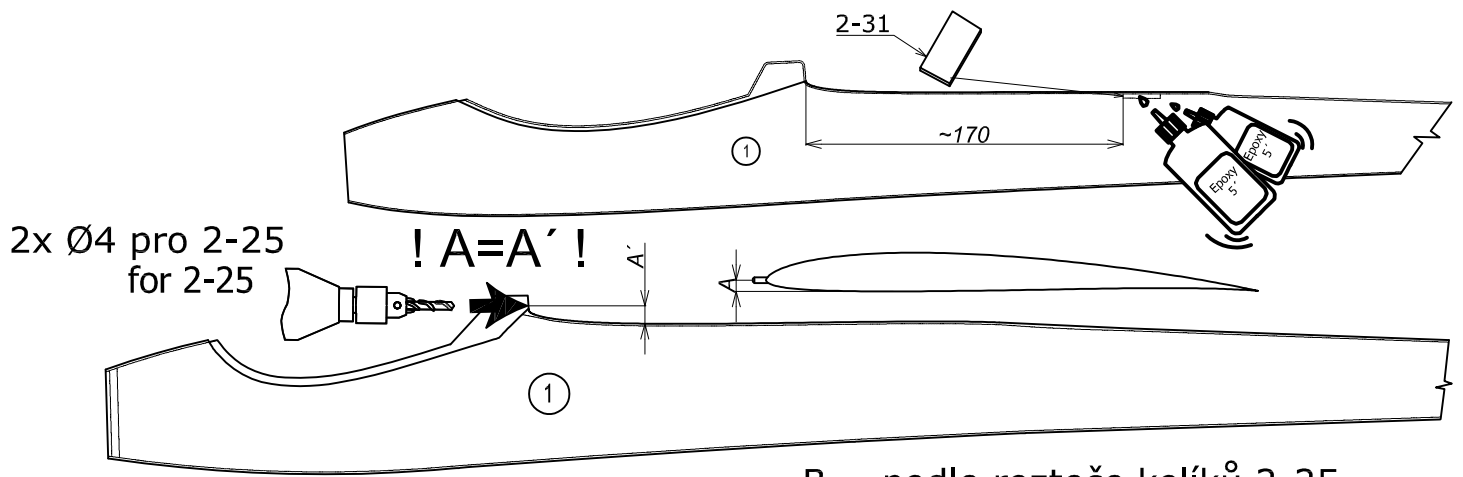



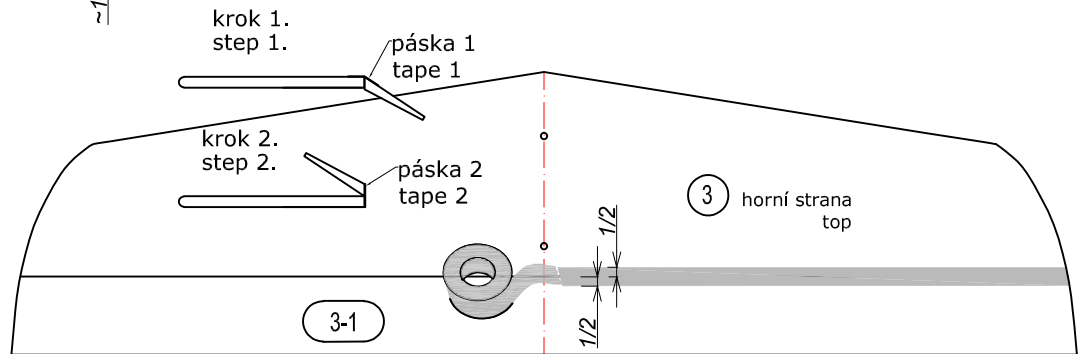
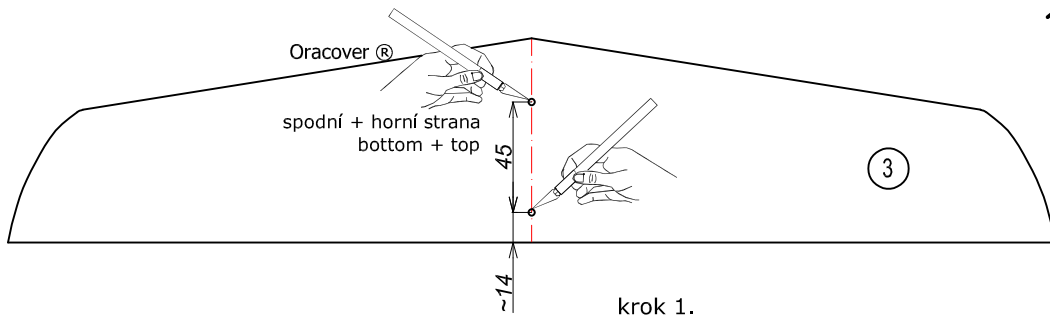
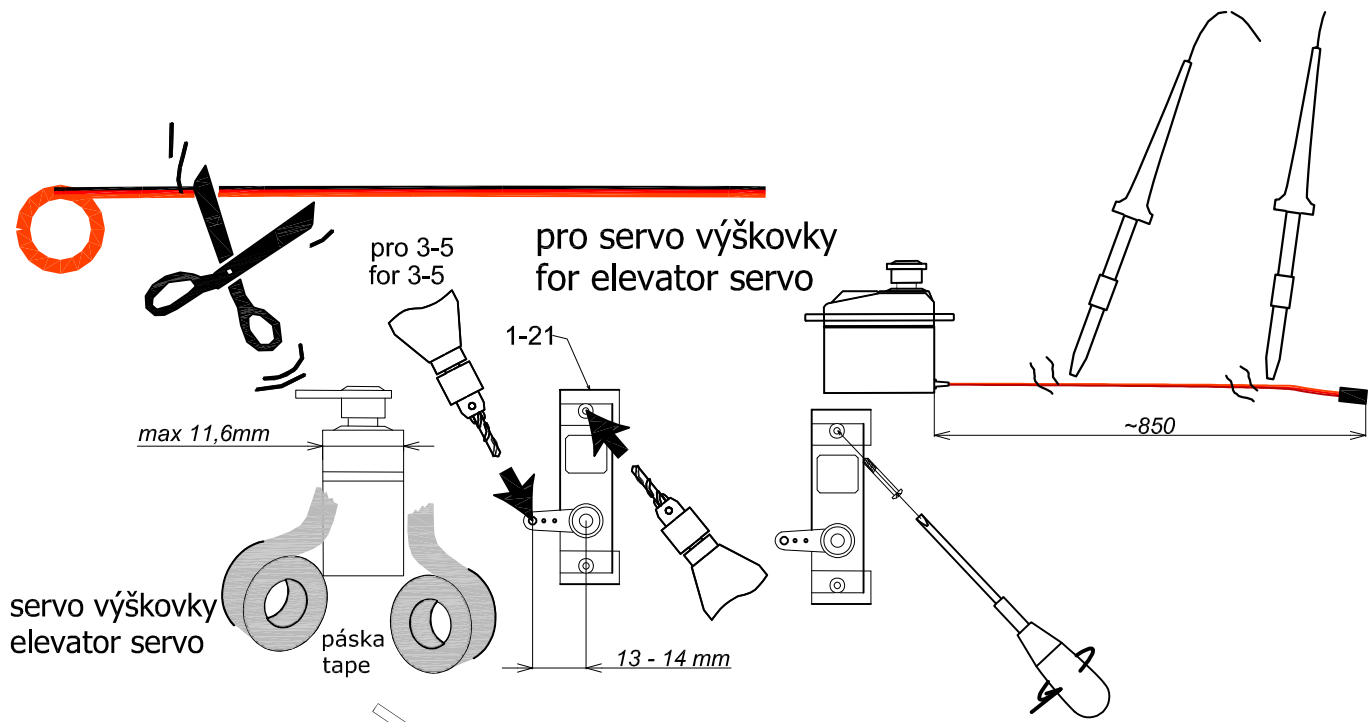

right side

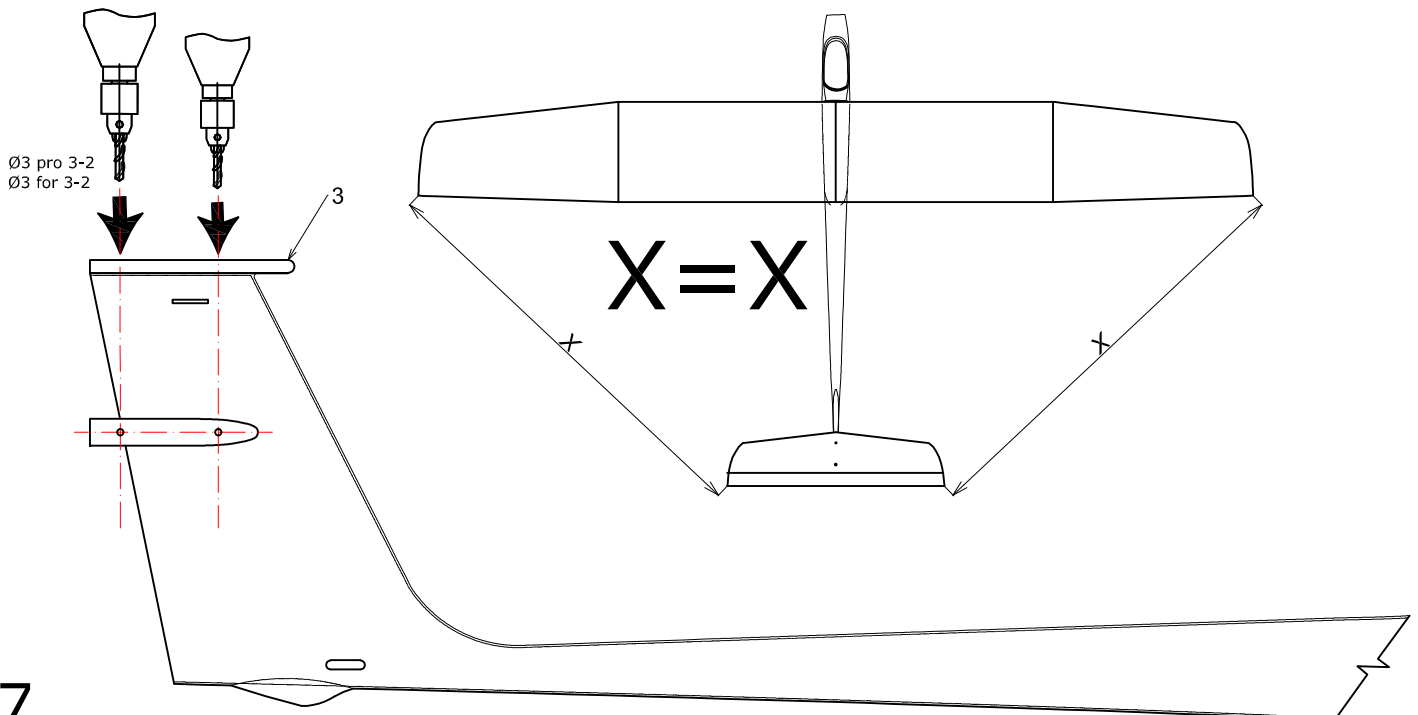

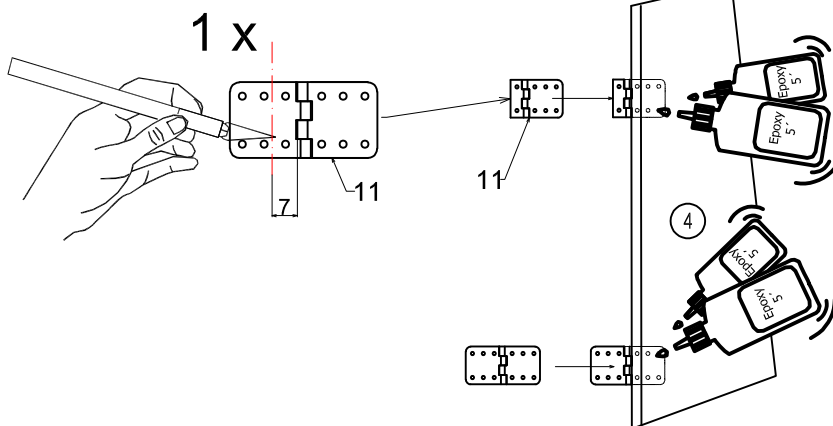
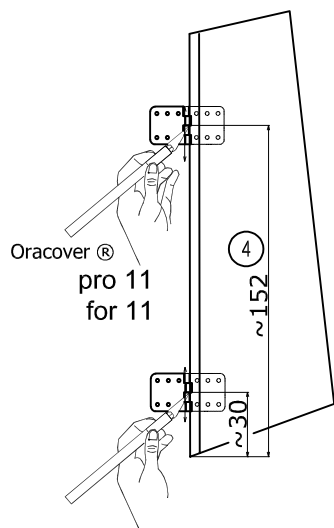
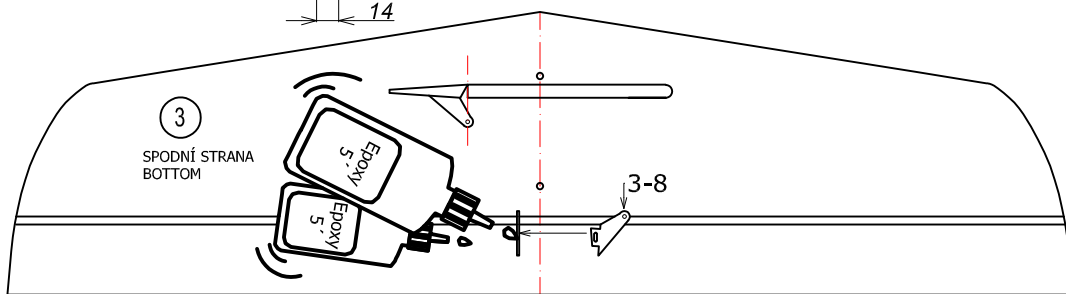
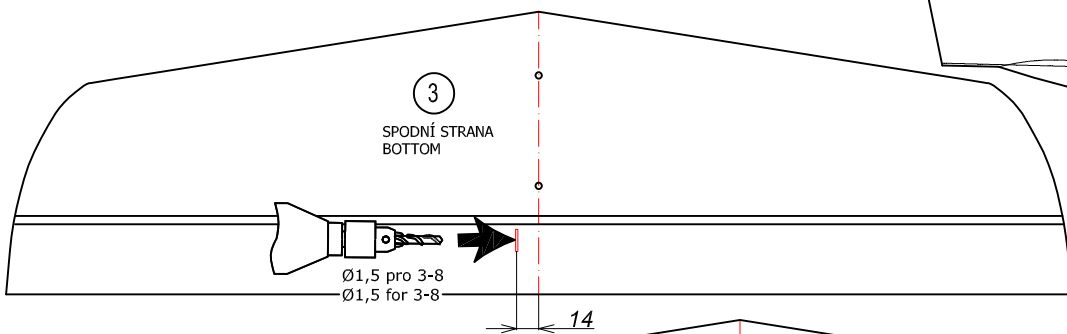
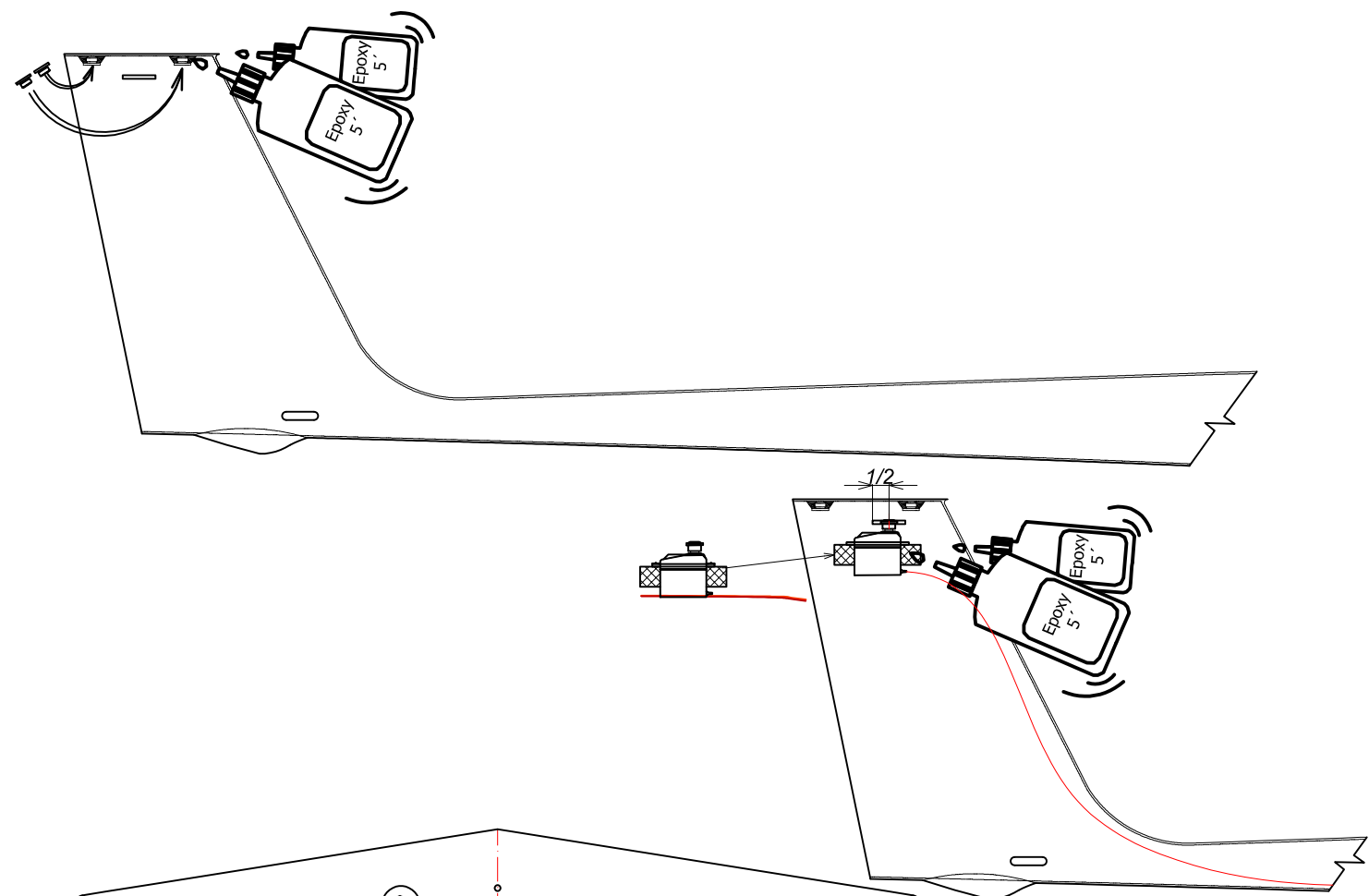

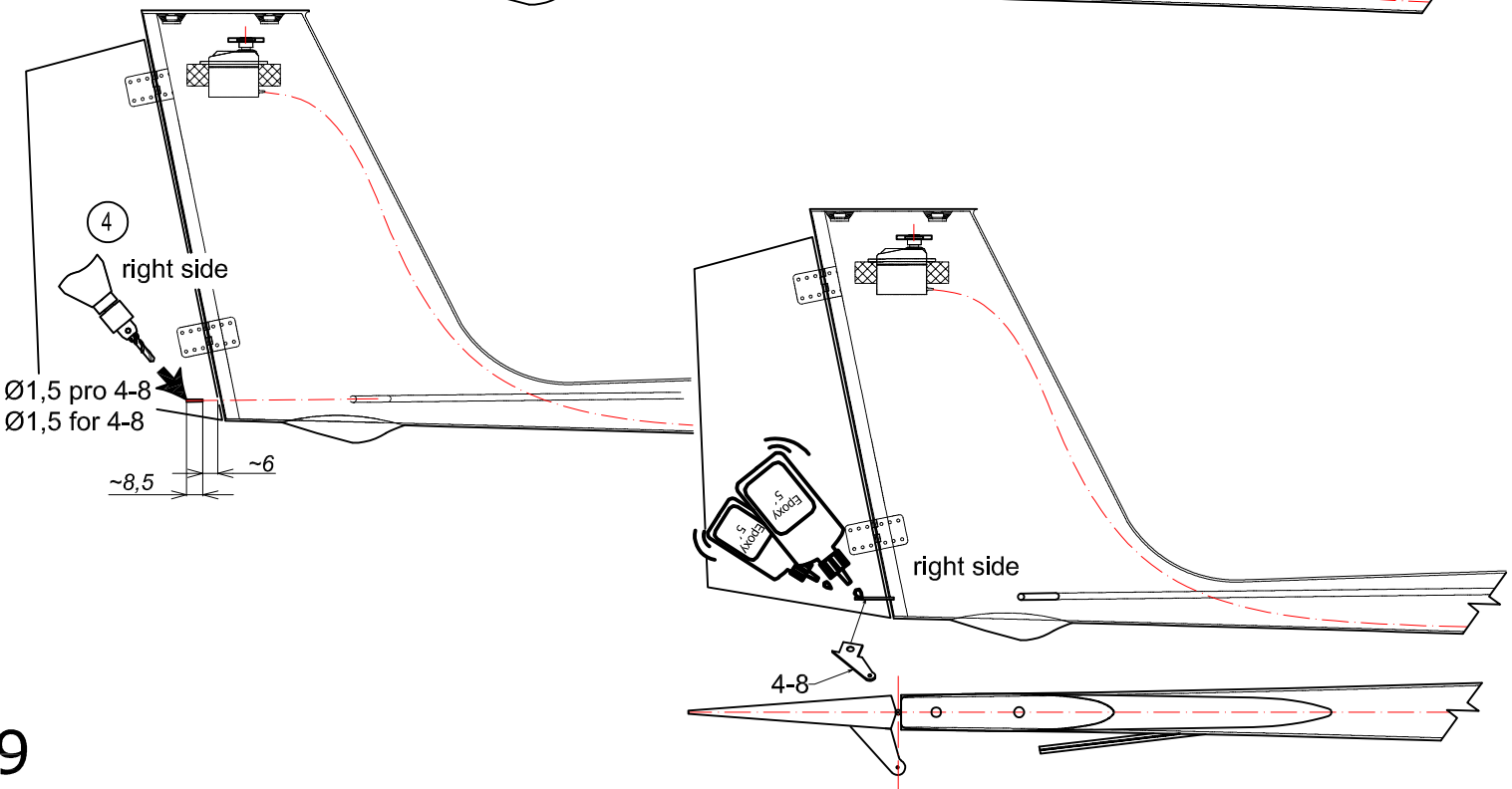
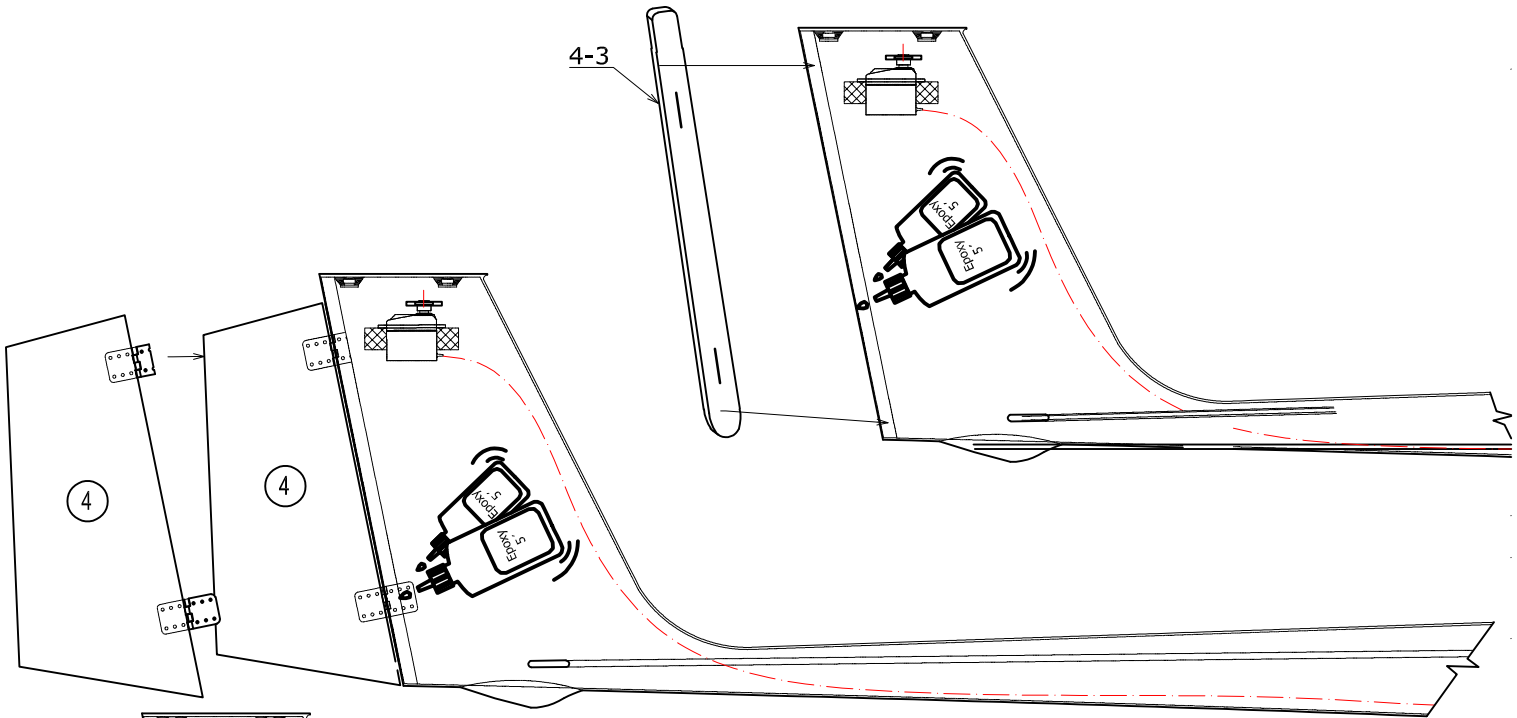
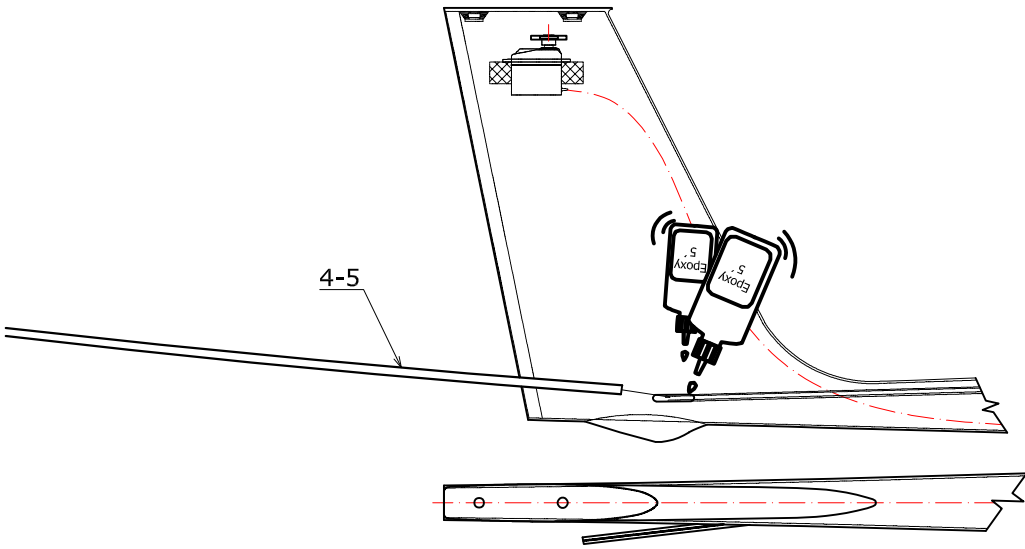

servo směrovky.  
rudder servo

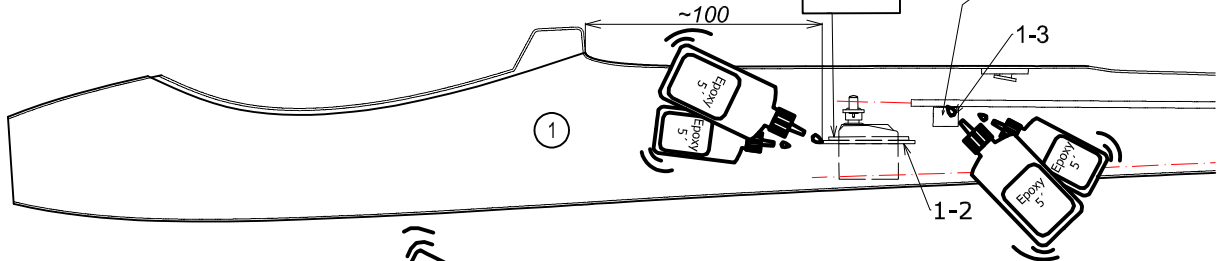
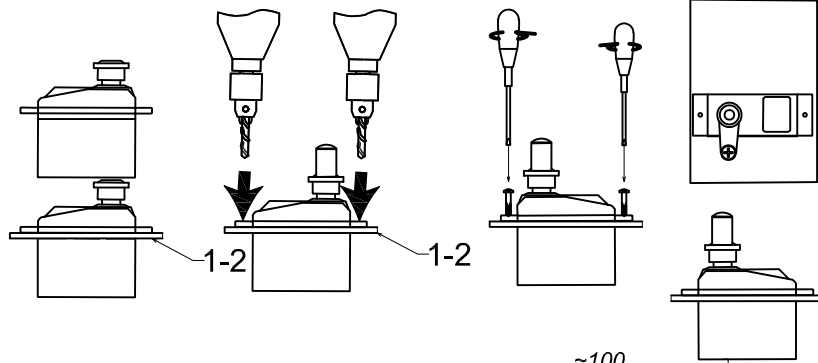
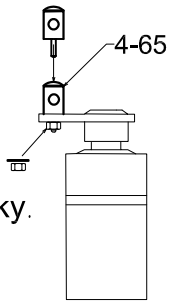

4-5 - Ø0,8

4-5 - Ø2

4-6

4-7

4-5 - Ø2

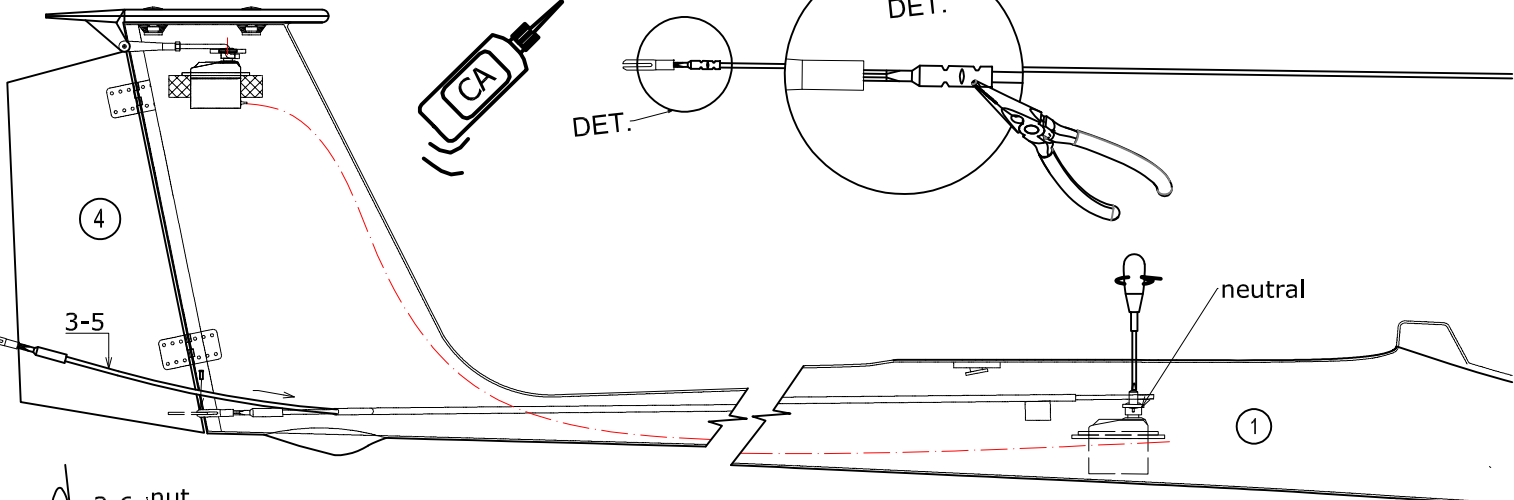
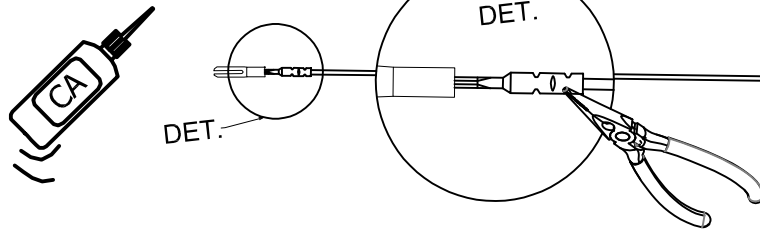

3-6 nut

3-5

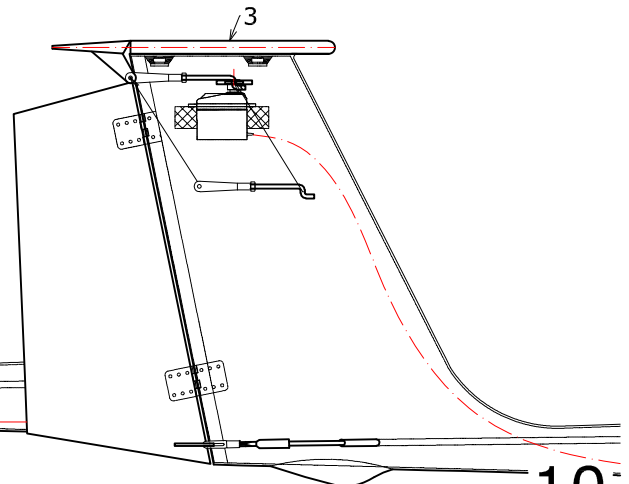
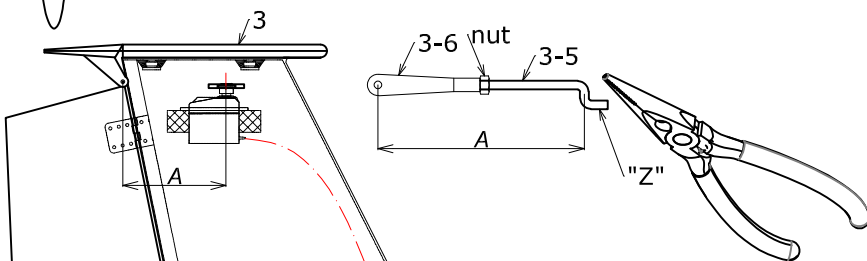

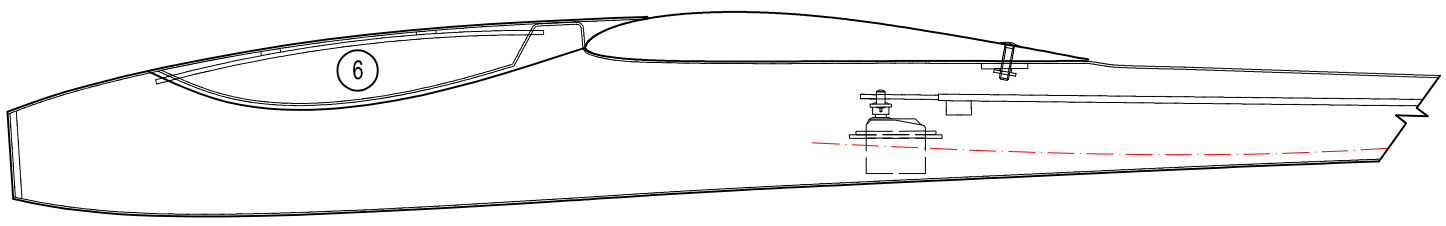
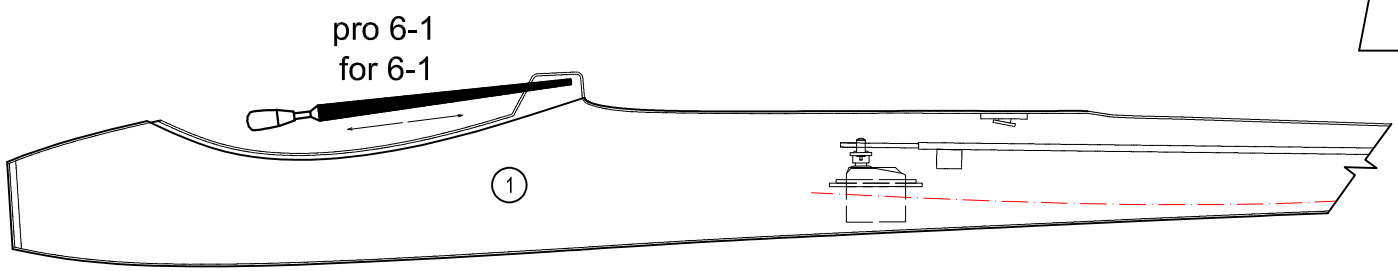
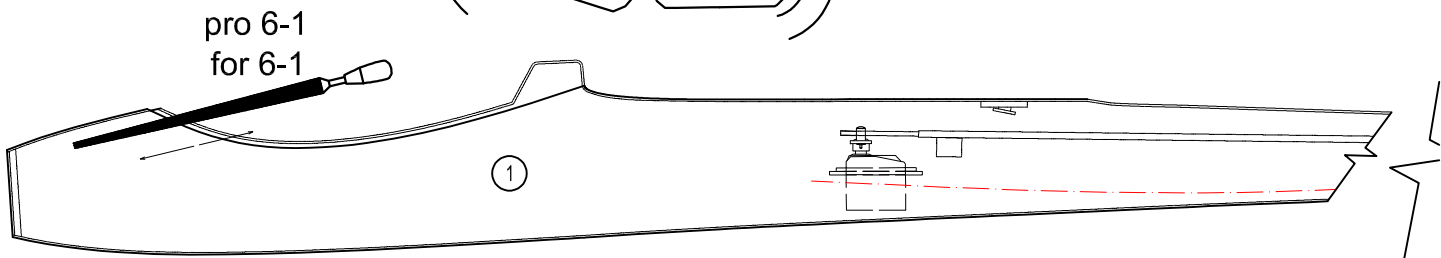
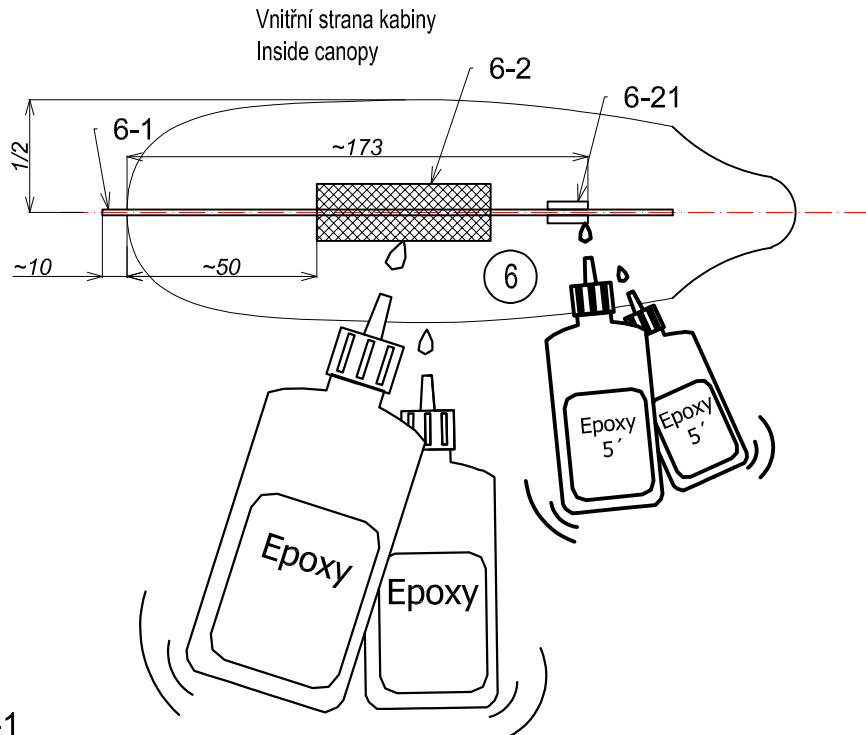
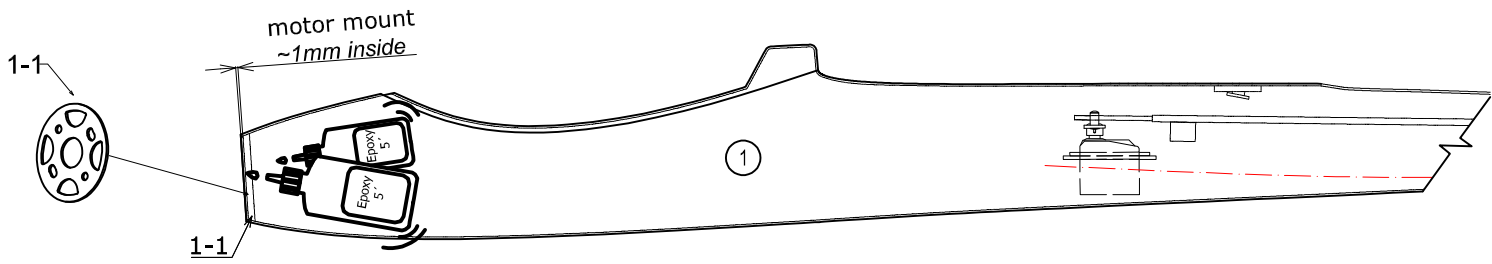

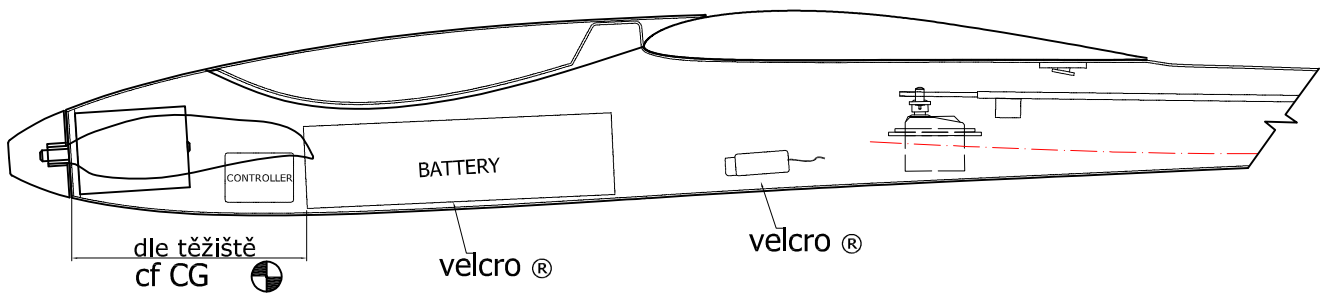
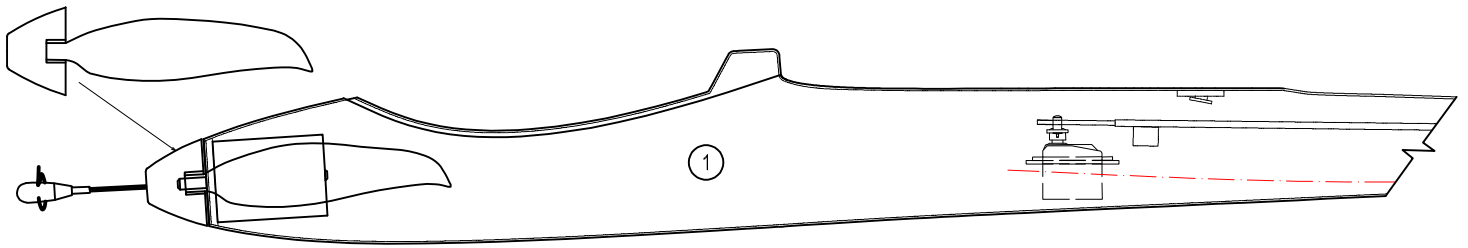
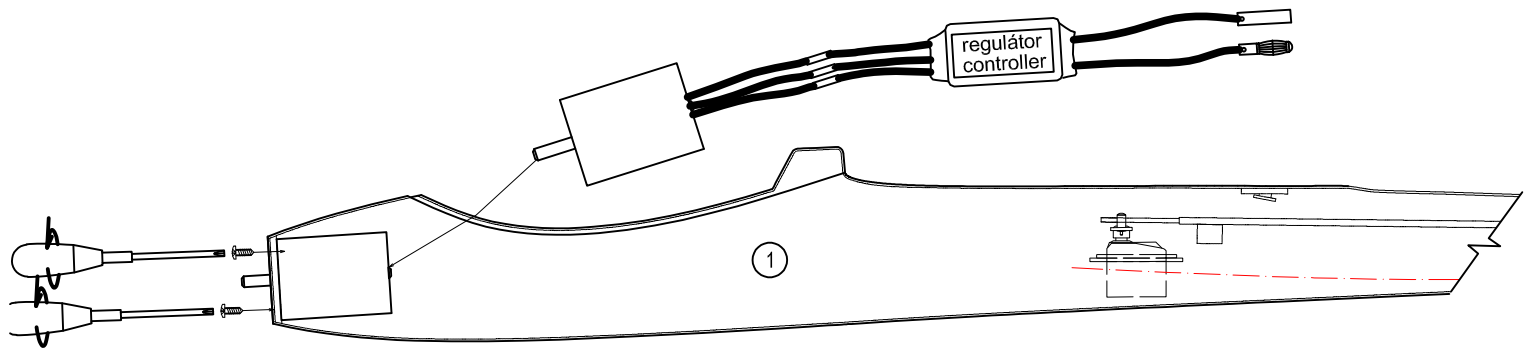
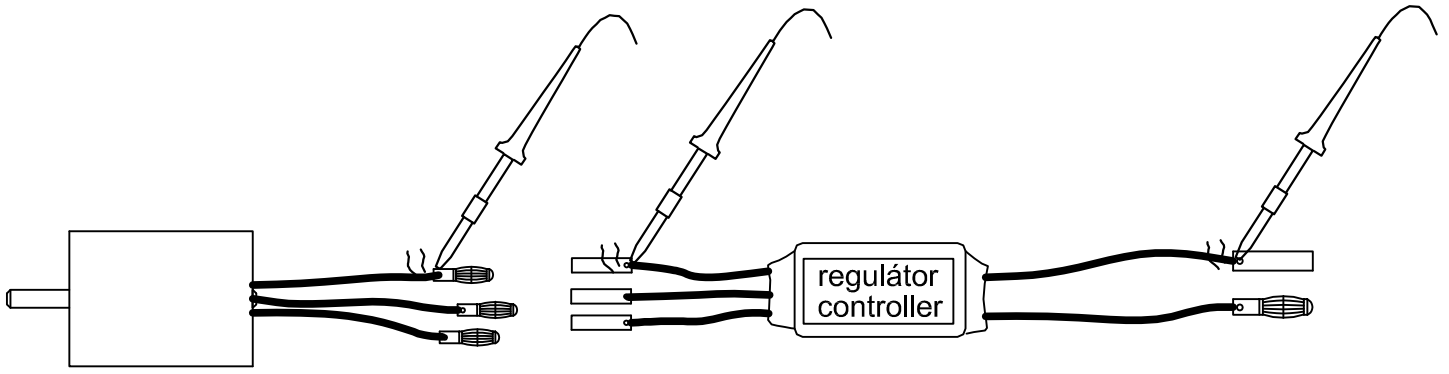

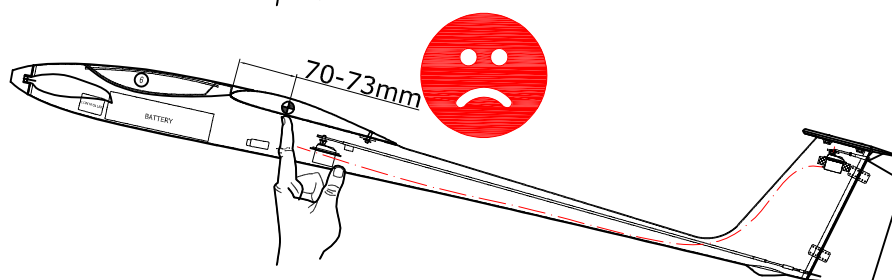
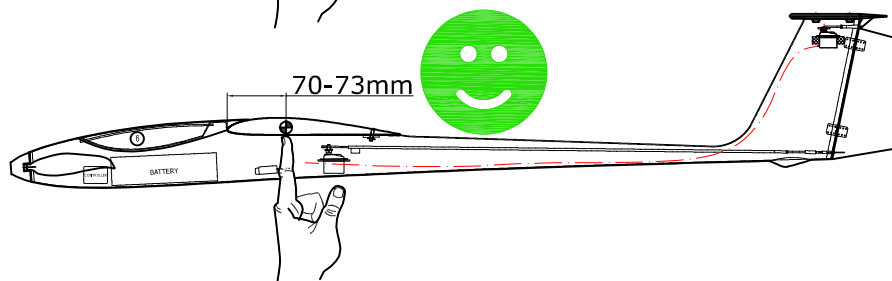
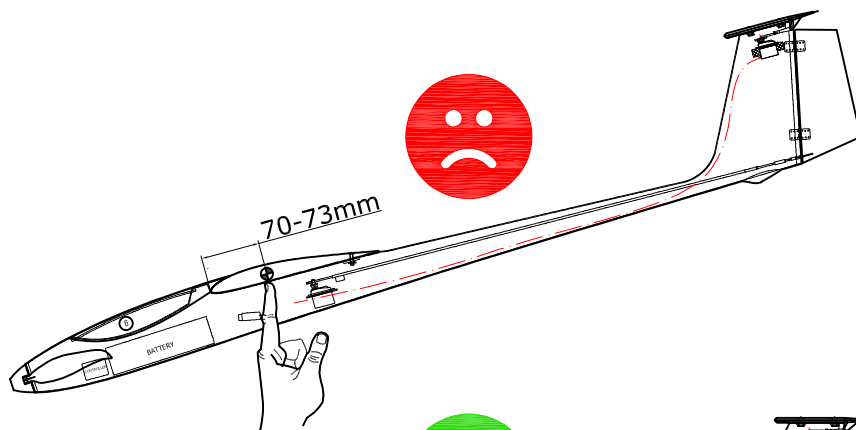
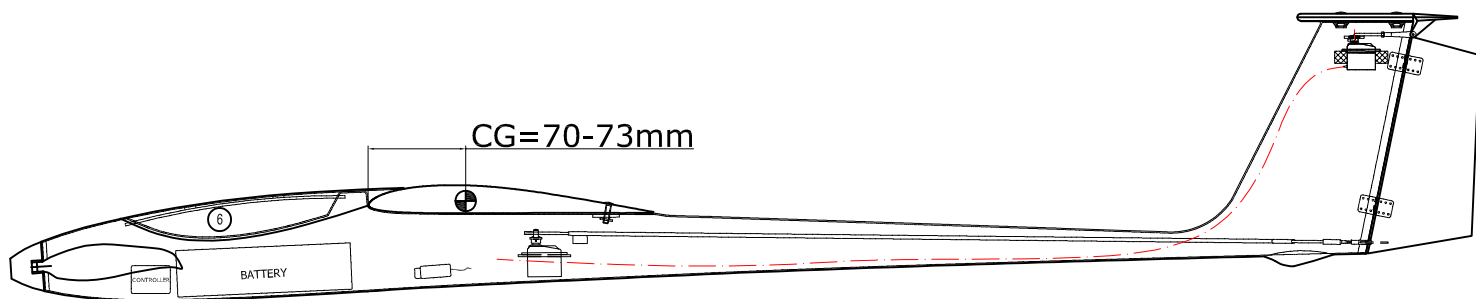

### Doporučené výchylky kormidel:

Křídélka: nahoru 30° - Expo 30%  
 dolů 15° - Expo 30%  
 Výškovka: nahoru 20 - 25° - Expo 30%  
 dolů 20 - 25° - Expo 30%  
 Směrovka: +- 40° - Expo 30%

### Nastavení pro létání termiky:

Křídélka jako klapky: dolů 2°  
 Klapky: dolů 3°  
 Výškovka: dle potřeby

### Nastavení pro přistání:

Klapky jako brzdy (butterfly): dolů 80°  
 Křídélka jako brzdy (butterfly): nahoru 15°  
 Výškovka: dolů -3 - 5° (kompenzace klopného momentu)

### Recommended angles of control surfaces:

Ailerons: up 30° - Expo 30%  
 down 15° - Expo 30%  
 Elevator: up 20 - 25° - Expo 30%  
 down 20 - 25° - Expo 30%  
 Rudder: +- 40° - Expo 30%

### Settings for thermal flying:

Ailerons works as flap: down 2°  
 Flap: down 3°  
 Elevator: up - compensation of overturning moment for flaps

### Settings for landing:

Flap works as airbrakes (for landing): down 80°  
 Ailerons works as airbrakes (for landing): up 15°  
 Elevator for landing: -3 - 5°  
 (suppression - compensation of overturning moment for flaps)